

LMP 952 - 954

Maximum pressure 25 bar
Flow rates to 3000 l/min



Technical data

Filter housing (Materials)

- Head: Anodized Aluminium
- Housing: Anodized Aluminium
- Manifolds: Welded - Phosphated Steel
- Bypass valve: Anodized Aluminium

Pressure

- Working pressure: 25 bar (2,5 MPa)
- Test pressure: 35 bar (3,5 MPa)

Temperature

- From -25 °C to +110 °C

Bypass valve

- Opening pressure 3,5 bar \pm 10%
- Other opening pressures on request.

Number of filter elements

- LMP 952: 2 filter elements CU950-3
- LMP 953: 3 filter elements CU950-3
- LMP 954: 4 filter elements CU950-3
- LMP 955: 5 filter elements CU950-3
- LMP 956: 6 filter elements CU950-3

Δp Elements type

- Microfibre filter elements series N: 20 bar
- Fluid flow through the filter element from OUT to IN.

Seals

- Standard NBR series A
- Optional FPM series V

LMP 952-954 FILTERS ARE PROVIDED FOR VERTICAL MOUNTING

Weights (kg)

Length	3
• LMP952	96
• LMP953	138
• LMP954	192

Volumes (dm³)

Length	3
• LMP952	66
• LMP953	99
• LMP954	132

Connections

- LMP 952-956: In-line Inlet/Outlet

Filter housings Δp pressure drop

The curves are plotted utilising mineral oil with density of 0,86 kg/dm³ to ISO 3968.

Δp varies proportionally with density.

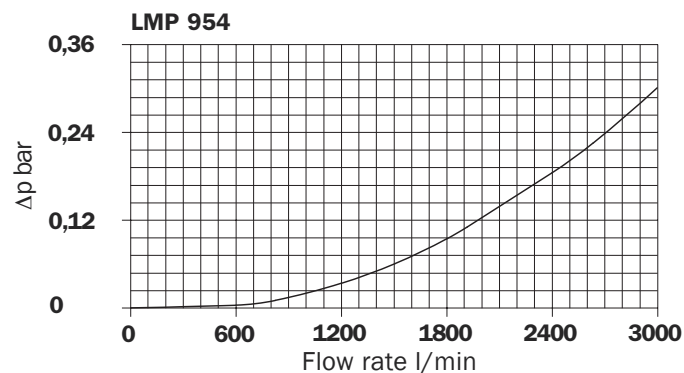
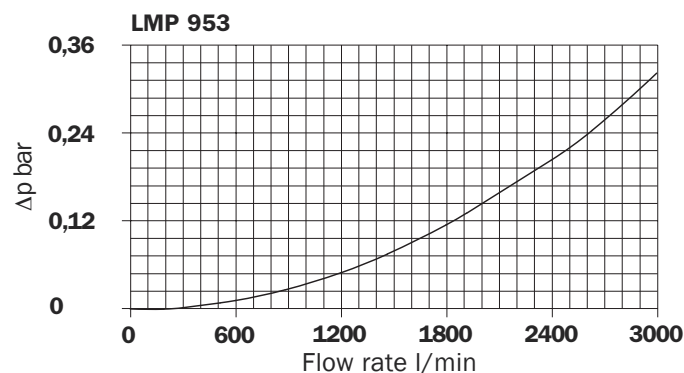
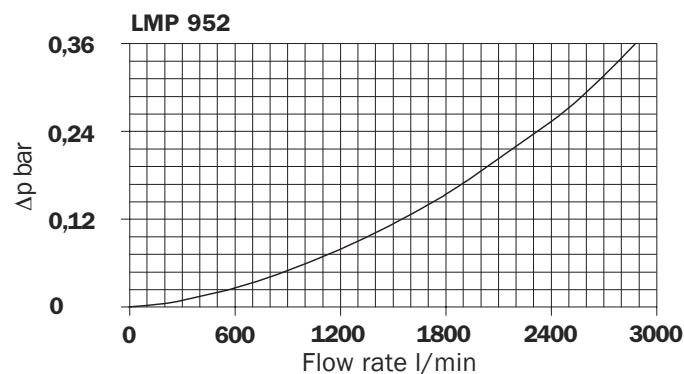

Valves

Bypass valve pressure drop

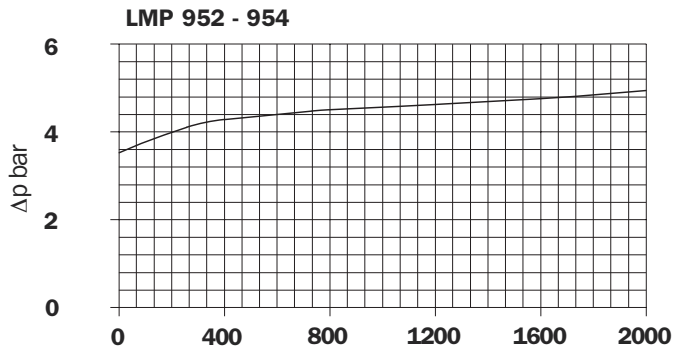

Pressure drop of filter complete with cartridge, oil viscosity 30 mm²/s (cSt)

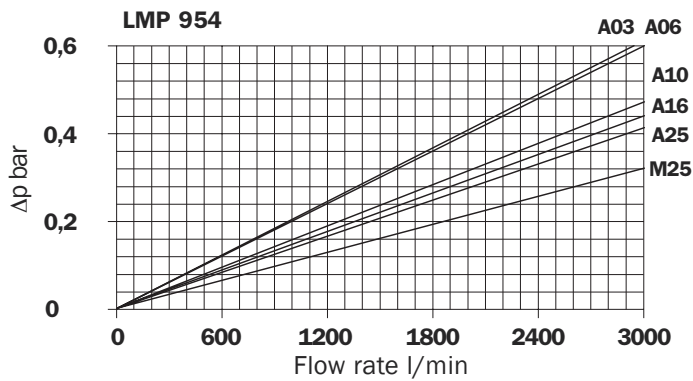
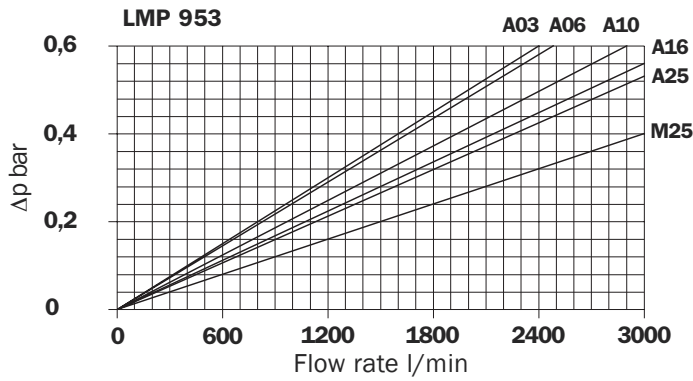
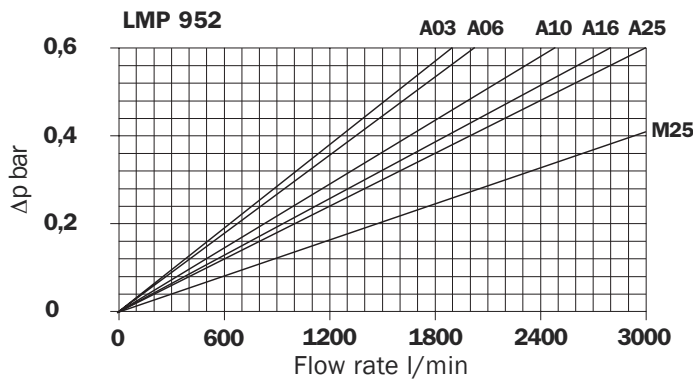

Option P02 for LMP 952 - 954

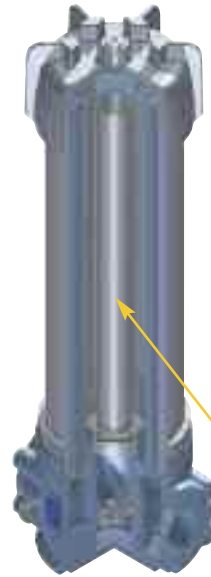

Option P02 "Internal tube for reduced flow rate" is recommended for flow rate values below:
 LMP 952 - 300 l/min
 LMP 953 - 450 l/min
 LMP 954 - 600 l/min
 The use of option P02 makes it easier to fill the housing with the operating fluid.

P02 "Internal tube for reduced flow rates"

Manifolds

Position of manifolds IN - OUT connections

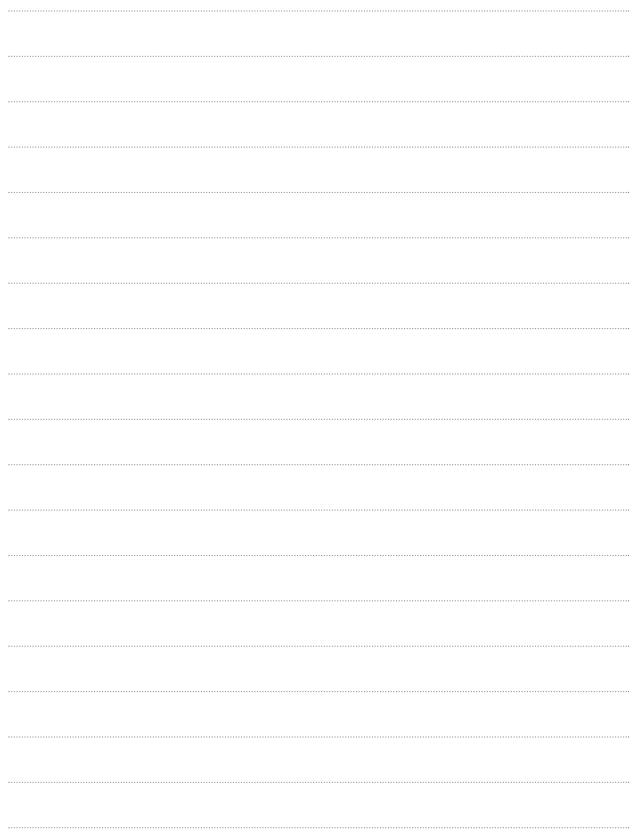
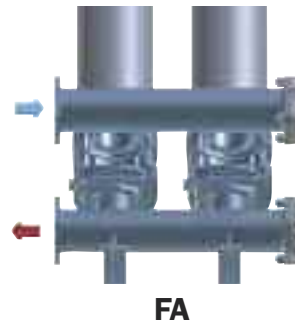

LMP 952

LMP 953

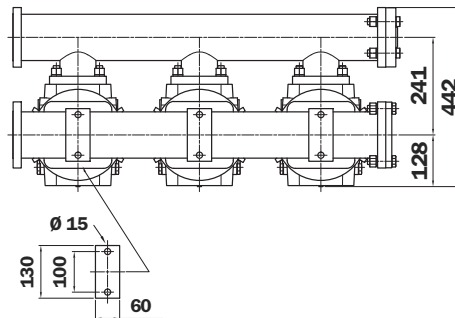
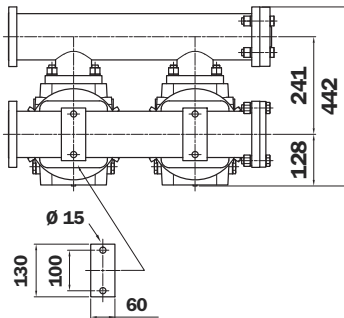
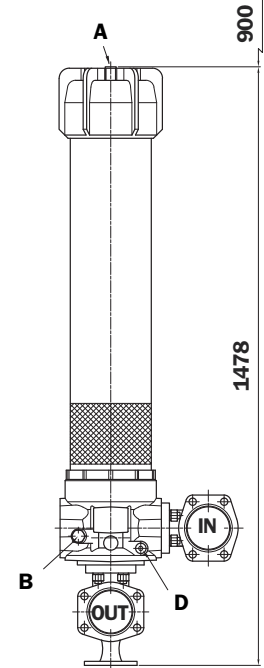
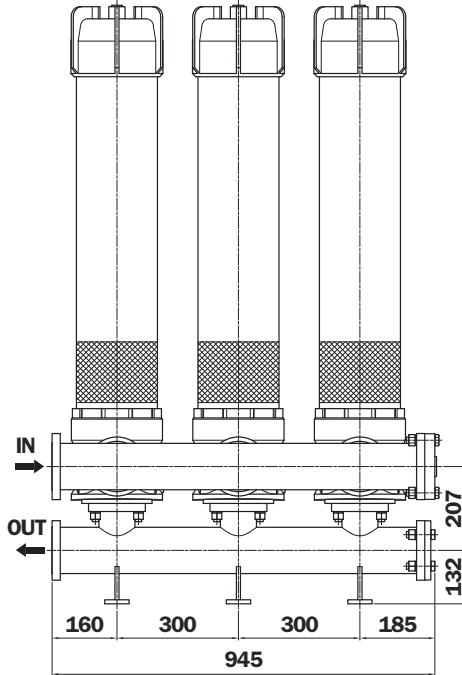
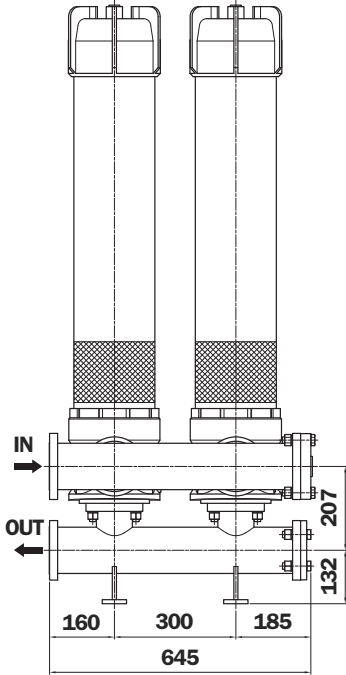

- A Breather plug
G 1/2" - A/F 10
- B Indicator port
Plug T2 - A/F 30
- D Oil drain plug
G 1/2" - A/F 10

Breather plug
G 1/2" - A/F 10

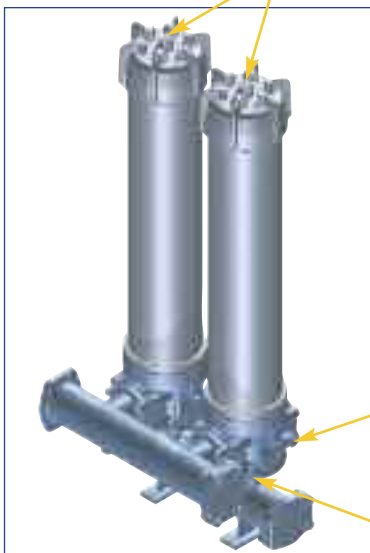

Indicator port
Plug T2 - A/F 30

Oil drain plug
G 1/2" - A/F 10

Indicator port
Plug T2 - A/F 30

Oil drain plug
G 1/2" - A/F 10

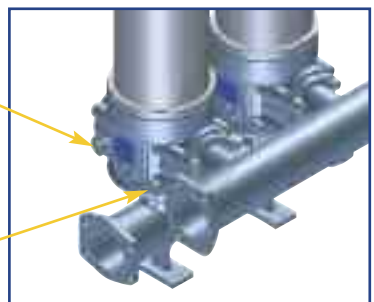

LMP 954

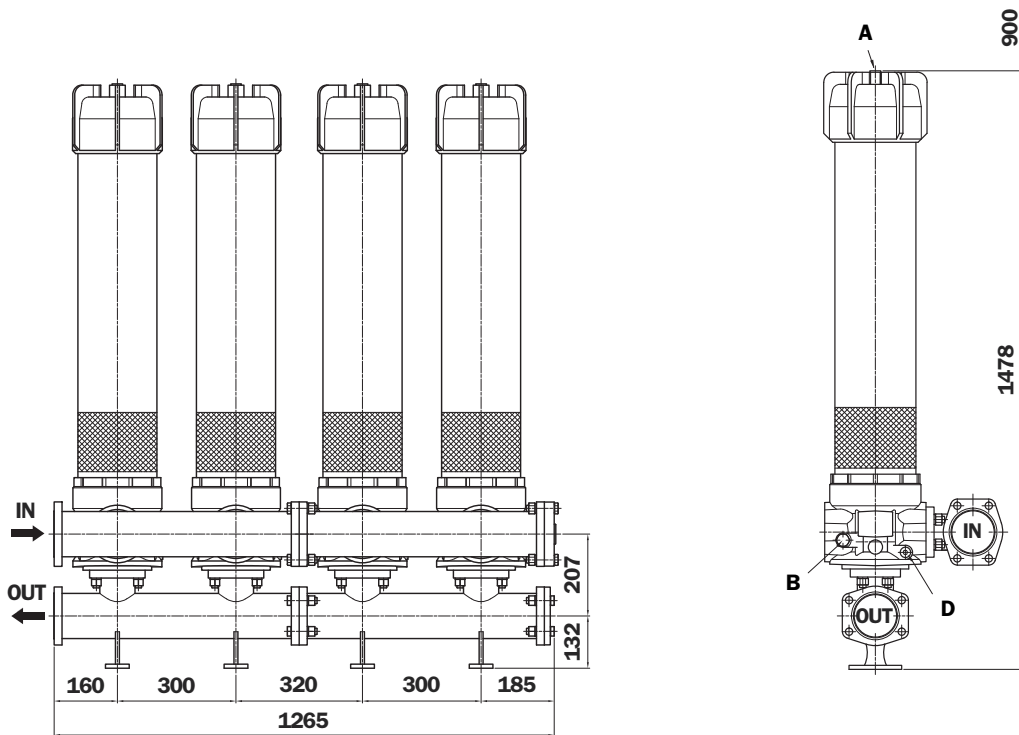

Option

Flange with oil drain plug for rapid discharge



Order code:

CMV4 - CUV4

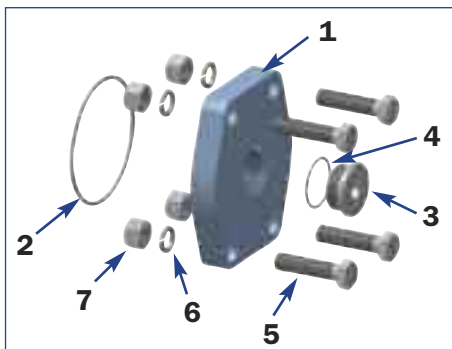

CMV4

Bill of materials:

- 1 4" SAE flange
- 2 O-R 4437 (FPM) for flange
- 3 Plug G 1-1/4"
- 4 O-R 3168 for plug (FPM)
- 5 No. 4 Hexagon bolt screws UNI-EN 24017 M16 x 65-10.9
- 6 No. 4 Spring washers UNI 1751-B 16
- 7 No. 4 Nuts UNI 5587 - M16

CUV4

Bill of materials:

- 1 4" SAE flange
- 2 O-R 4437 (FPM) for flange
- 3 Plug SAE 20 1 5/8" - 12 UN
- 4 1147 O-R for plug (FPM)
- 5 No. 4 Hexagon bolt screws 5/8" UNC x 2 1/2"
- 6 No. 4 Spring washers UNI 1751-B 16
- 7 No. 4 Nuts 5/8" UNC

Oil drain plug

Code	CMV4	CUV4
Thread	G 1 1/4"	SAE 20

Spare parts

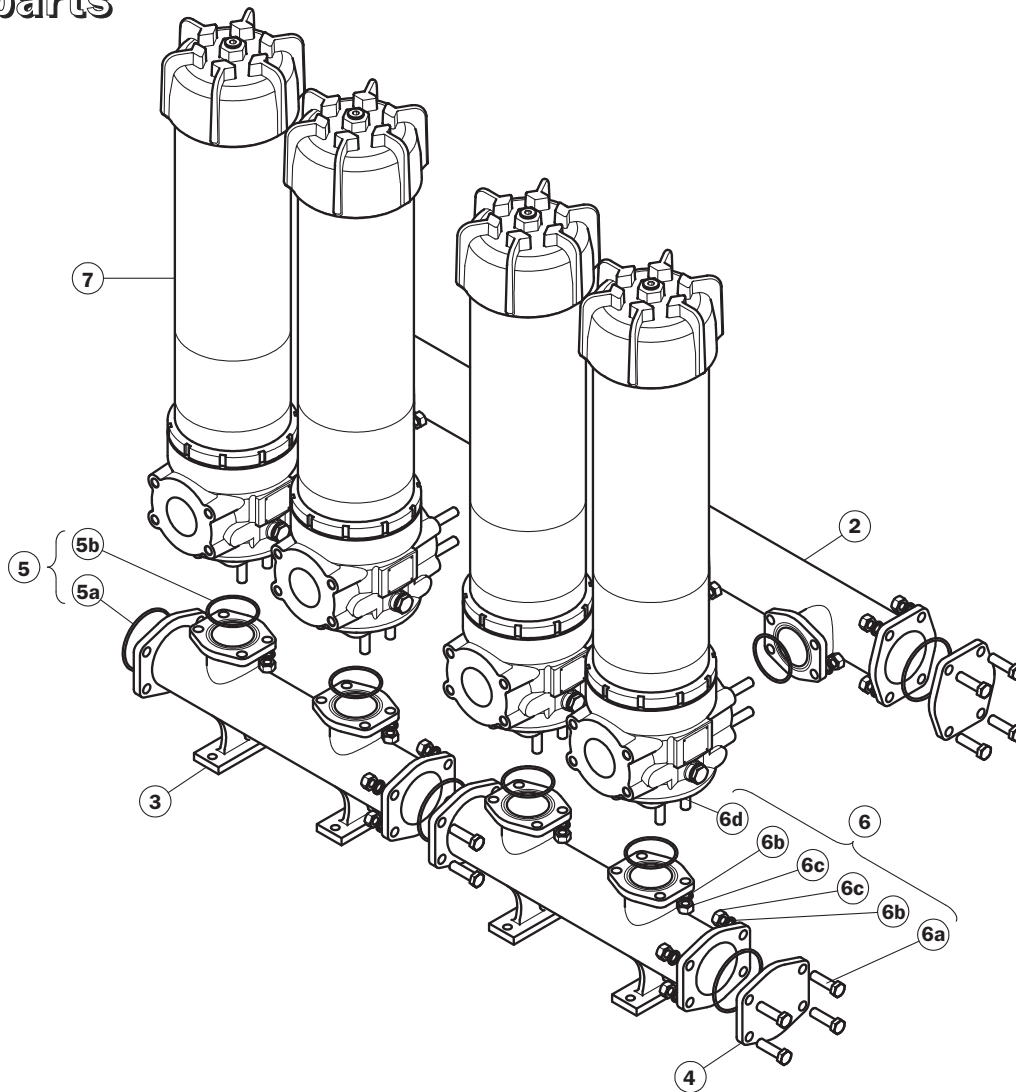

Item	Description	Q. ty			FILTER Series					
		LMP 952	LMP 953	LMP 954	LMP 952		LMP 953		LMP 954	
1	Filter assembly	1	1	1	See order table					
2	IN manifold	1	1	2	01039270		01039272		01039270	
3	OUT manifold	1	1	2	01039271		01039273		01039271	
4	4" SAE 3000 psi plugged flange	2	2	2	01042020					
5	Manifolds seal kit	1	1	1	NBR	FPM	NBR	FPM	NBR	FPM
					02050404	02050405	02050404	02050405	02050406	02050407
5a	IN-OUT O-Ring	4	4	6	O-R 4437 Ø 110,7 x 3,53					
5b	Manifolds/filter O-Ring	4	6	8	O-R 4337 Ø 85,32 x 3,53					
6	Threaded fasteners kit	1	1	1	02049051		02049052		02049053	
6a	Hexagon bolt screws	8	8	16	EN ISO 4017-M16x70-10.9					
6b	Spring washers	24	32	48	UNI 1751-B - DIN 127-B 16					
6c	Nuts	24	32	48	DIN 934-M16-10					
6d	Studs	16	24	32	UNI 5911-M16x40-10.9					
7	Filter	2	3	4	See order table LMP9513xxF1xxxNPOx page 241					
-	Filter spare parts Item 7	2	3	4	See spare parts table LMP 951 page 240					
-	Filter seals kit Item 7	2	3	4	See spare parts table LMP 951 page 240					

Ordering information LMP 952 - 954

Filter assembly LMP

	1	2	3	4	5	6	7	8a
	<input type="checkbox"/>	<input type="checkbox"/>	<input type="checkbox"/>	<input type="checkbox"/>	<input type="checkbox"/>	<input type="checkbox"/>	<input type="checkbox"/>	<input type="checkbox"/>
Example: LMP	953	3	B	A	FA	A10	N	P01

Filter element CU

	1	2	6	4	7	8b
	<input type="checkbox"/>	<input type="checkbox"/>	<input type="checkbox"/>	<input type="checkbox"/>	<input type="checkbox"/>	<input type="checkbox"/>
Example: CU	950	3	A10	A	N	P01 (nr. 3 filter elements required)

1 - Style

Filter

952
 953
 954

Filter element

950 2 filter elements
 950 3 filter elements
 950 4 filter elements

2 - Filter length

952
 953
 954

3 With 1 CU 950 cartridge
 3 With 2 CU 950 cartridges
 3 With 3 CU 950 cartridges

3 - Valves

S Without bypass
 B With bypass

4 - Filter seals

A NBR
 V FPM

5 - Connections

Flange 4" SAE 3000 PSI
 See page 245

6 - Filter element

<input type="checkbox"/> A03	Inorganic microfibre 3 µm	} Absolute filtration Inorganic Microfibre βx (c) ≥ 1000
<input type="checkbox"/> A06	Inorganic microfibre 6 µm	
<input type="checkbox"/> A10	Inorganic microfibre 10 µm	
<input type="checkbox"/> A16	Inorganic microfibre 16 µm	
<input type="checkbox"/> A25	Inorganic microfibre 25 µm	
<input type="checkbox"/> M25	Wire mesh 25 µm	} Nominal Filtration
<input type="checkbox"/> M60	Wire mesh 60 µm	
<input type="checkbox"/> M90	Wire mesh 90 µm	

7 - Max filter element differential pressure

N Δp 20 bar

8 - Option

a - Filter

P01 MP Filtri standard
 P02 With internal tube for reduced flow rate
 Pxx Customer request

b - Filter element

P01 MP Filtri standard
 Pxx Customer request

Option:

Flange with rapid discharge oil drain plug

See page 245

CMV4 Plug G 1 1/4"
CUV4 Plug SAE 20

For Clogging Indicator:
 See page 324

MP Filtri - The filter functions as described in this bulletin are valid exclusively for original MP Filtri filter elements and replacement parts. All rights reserved.

The data in this publication are purely guideline. MP Filtri reserves the right to make changes to the models described herein at any time it deems fit in relation to technical or commercial requirements. The colours of the products shown on the cover are purely guideline. Copyright. All rights reserved.